



## SMD PULSE TRANSFORMER CMTA Series

### 片式网络变压器 CMTA Series

#### ● FEATURES 特性

1. Meets IEEE 802.3 Standards.  
满足IEEE 802.3标准
2. Designed For 1G BASE-T Applications, Surface Mount Type.  
表面贴装, 为1G BASE-T 应该设计。
3. Operating Temp.:  $-40^{\circ}\text{C} \sim +85^{\circ}\text{C}$   
工作温度:  $-40^{\circ}\text{C} \sim +85^{\circ}\text{C}$

#### ● PART NUMBERING SYSTEM 品名系统

CTMA 4532 201

A B C

A: Type 型号 B: External Dimensions 外形尺寸 A\*C

C: 感量 201:200uH 最小

#### ● SHAPES AND DIMENSIONS 外形尺寸 (Unit:mm)

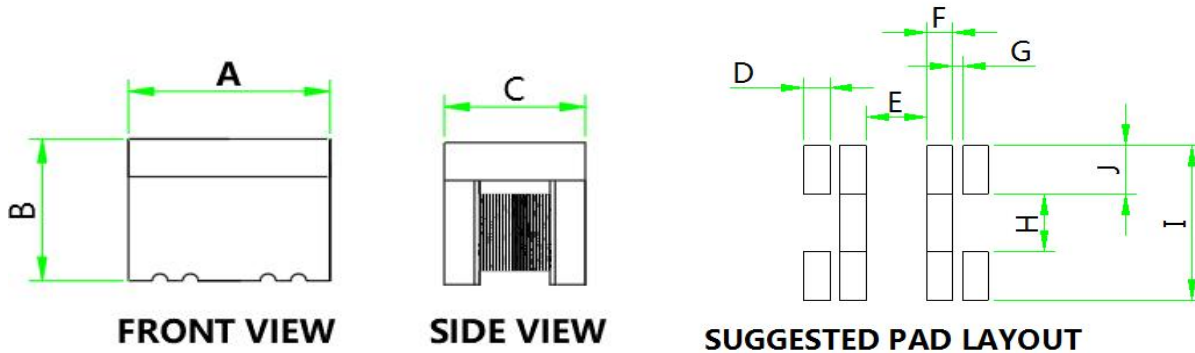

| TYPE(型号) | A       | B      | C       | D      | E       | F      | G       | H      | I      | J      |
|----------|---------|--------|---------|--------|---------|--------|---------|--------|--------|--------|
| CMTA4532 | 4.5±0.2 | 3.5Max | 3.2±0.2 | 0.6TYP | 1.84TYP | 0.6TYP | 0.17TYP | 1.4TYP | 3.2TYP | 0.9TYP |

● SPECIFICATION TABLE:

CMTA4532 Series

| Part No.     | Inductance<br>(uH).<br>Min | Test Condition             | DCR<br>(Ω) Max | Turn<br>Ratio(±5%) | Insertion<br>Loss<br>(dB Max) | Return Loss(dB Min) |                | HI-POT<br>(V) | C <sub>ww</sub> (pF)<br>(TYP),100KHz<br>,0.1V |
|--------------|----------------------------|----------------------------|----------------|--------------------|-------------------------------|---------------------|----------------|---------------|---|
|              |                            |                            |                |                    | 0.5-100MHz                    | 0.5-40MHz           | 40.1-100MHz    |               |   |
| CMTA4532-151 | 150                        | 100KHz/0.1V<br>8mA DC Bias | 3.50           | 1CT:1CT            | 1.5                           | 18                  | 12-20log(f/80) | 1500,1S       | 40  |
| CMTA4532-201 | 200                        | 100KHz/0.1V<br>8mA DC Bias | 3.50           | 1CT:1CT            | 1.5                           | 18                  | 12-20log(f/80) | 1500,1S       | 40  |

● **PACKAGING SPECIFICATION :**

1. Packaging - Cover Tape

The force for tearing off cover tape is 10 to 100 grams in the arrow direction.

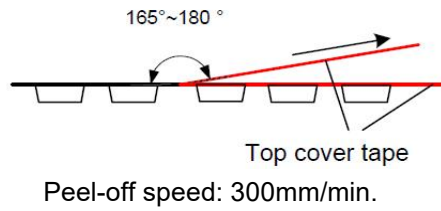
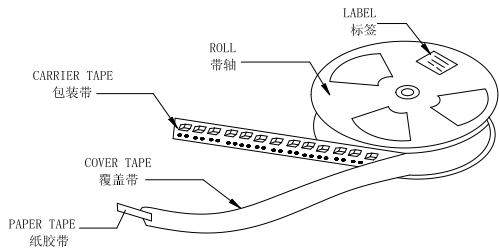

2. Packaging - Tape & Reel

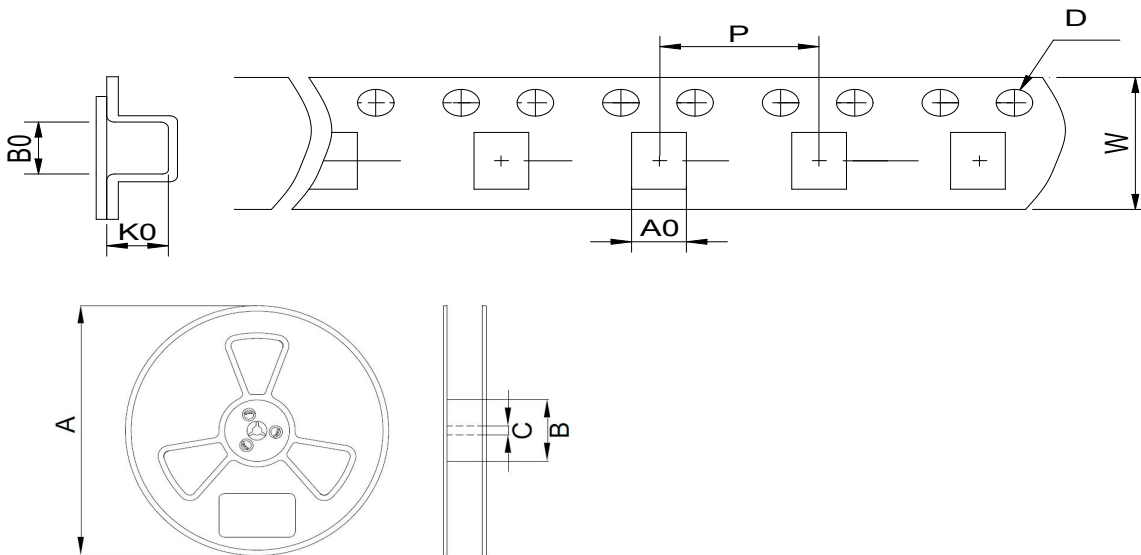

| Type     | Tape Dimension (mm) |     |      |    |     |   | Reel Dimension (mm) |    |    | Quantity (Pcs/Reel) |
|----------|---------------------|-----|------|----|-----|---|---------------------|----|----|---------------------|
|          | W                   | A0  | B0   | K0 | D   | P | A                   | B  | C  |                     |
| CMTA4532 | 12                  | 3.7 | 4.85 | 3  | 1.5 | 8 | 178                 | 60 | 13 | 500 pcs             |

